

# LIFTING EYE ANCHOR

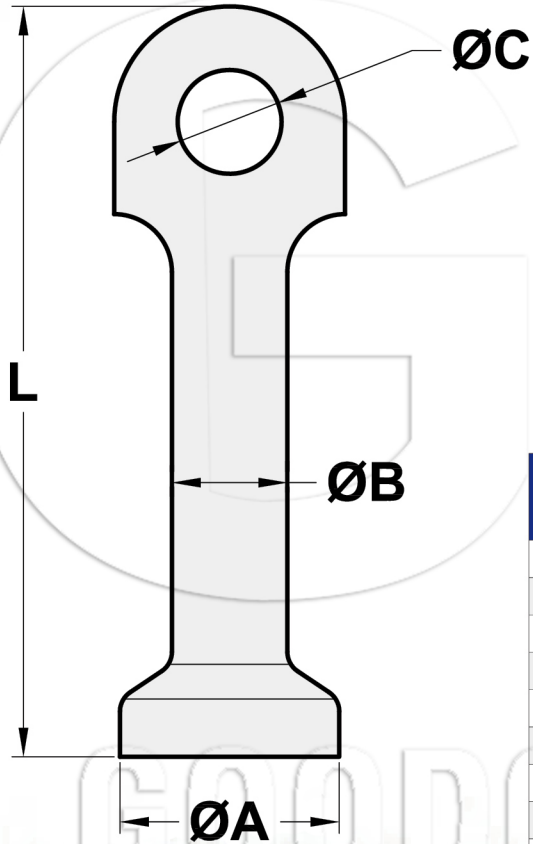

Size	Load Group (t)	Dimensions (mm)			
		A	B	C	L
1.3 × 55	1.3	19	10	9	55
2.5 × 90	2.5	26	14	13	90
2.5 × 120	2.5	26	14	13	120
5 × 90	5	36	20	18	90
5 × 120	5	36	20	18	120
10 × 115	10	47	28	25	115
10 × 180	10	47	28	25	180
20 × 250	20	70	39	37	250
32 × 300	32	88	50	47	300