

WLEDLESS END LINKS

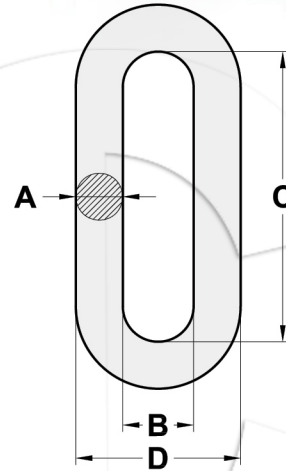

Size (in.)	Working Load Limit (lbs.)	Weight Each (lbs.)	Dimensions (in.)			
			A	B	C	D
5/16	2500	0.15	0.31	0.50	1.75	1.18
3/8	3800	0.22	0.38	0.56	1.88	1.38
1/2	6500	0.49	0.50	0.75	2.38	1.81
5/8	9300	0.97	0.63	1.00	3.25	2.32
3/4	14000	1.51	0.75	1.13	3.50	2.68
7/8	12000	2.59	0.88	2.00	5.13	3.75
1	15200	3.95	1	2.25	5.75	4.25
1-1/4	26400	7.30	1.25	2.50	7.00	5.00
1-3/8	30000	10.38	1.38	2.75	7.75	5.50

⚠ WARNING Never exceed Working Load Limit