

US TYPE STEEL OVAL SLEEVES

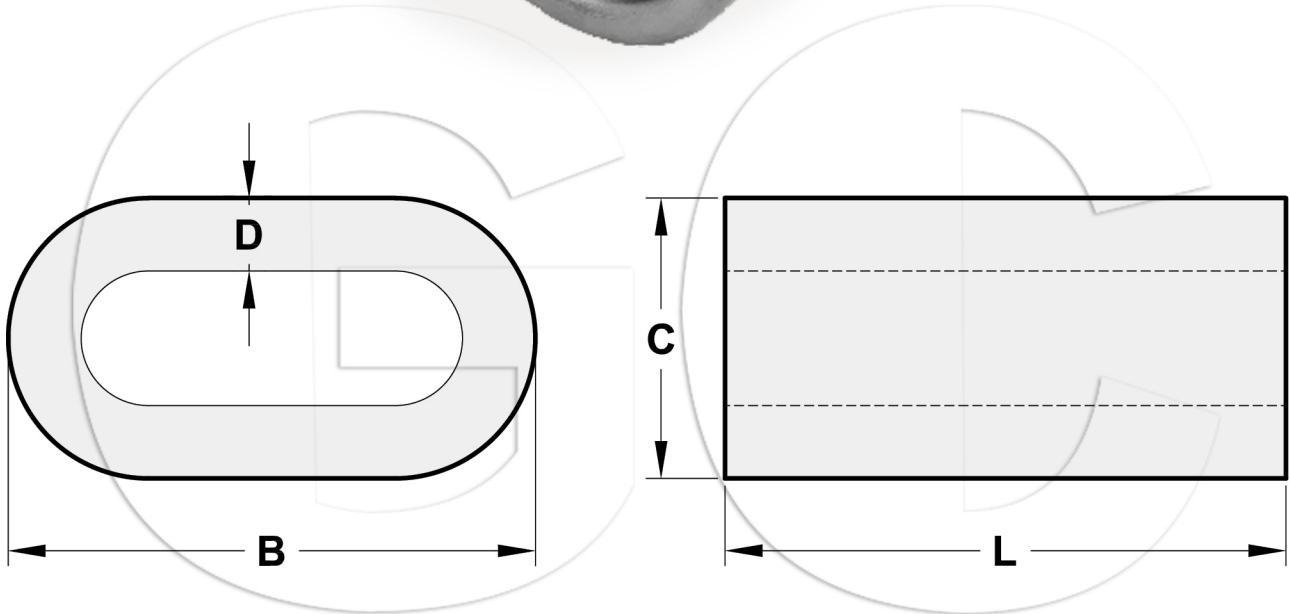

- Specially processed low carbon steel
- Note: Steel Oval Sleeves are recommended for use with 6x19 or 6x37, IPS ORxIP(EIP), RRL, FC or IWRC wire rope

Rope Size (in)	Weight Per 100 (kg)	Dimensions (mm)				Max after Swage DIA. (mm)
		L	B	C	D	
5/16	77.1	31.8	26.9	20.6	4.85	19.6
3/8	59	31.8	28.4	20.6	3.55	19.6
7/16	141	41.4	35.8	25.9	4.85	26.2
1/2	122	41.4	36.6	25.9	4.05	26.2
9/16	286	57.0	43.7	31.2	5.85	32.8
5.8	245	57.0	46.7	32.5	5.10	32.8
3/4	413	67.0	55.0	38.6	5.85	39.4
7/8	570	73.0	63.5	44.5	6.85	45.7
1	850	77.5	72.0	51.0	8.40	52.0
1-1/4	1740	103	89.0	63.5	9.65	65.0