

ALUMINIUM FERRULES JIS TYPE

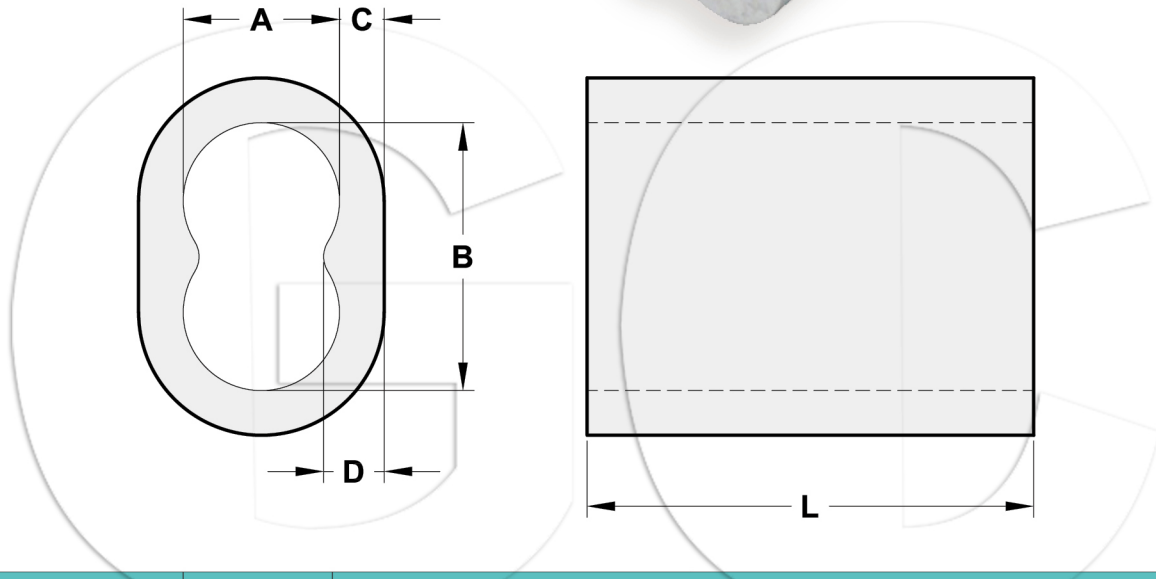

Ferrule Code	Weight Per 1000 (kg)	Dimensions (mm)				
		A	B	C	D	L
6	10	7.00	13.80	3.20	3.80	24
7	14	8.20	16.20	3.60	4.25	26
8	22	9.40	18.60	4.00	4.70	32
9	29	10.22	20.70	4.30	5.52	36
10	37	11.60	23.00	4.50	5.50	40
12	63	13.62	27.60	5.30	6.92	48
14	88	15.89	32.20	5.53	7.42	56
16	130	18.16	36.80	6.32	8.48	64
18	186	20.43	41.40	7.11	9.54	72
20	245	23.10	46.00	7.70	9.20	80
22	319	25.40	50.60	8.30	10.00	88
24	408	27.80	55.30	8.90	10.90	96
26	581	29.90	59.80	10.70	12.90	104
28	714	32.20	64.40	11.30	13.60	112
30	859	34.50	69.00	11.80	14.30	120
32	1026	36.80	73.60	12.50	15.20	128
34	1257	39.10	78.20	13.30	16.20	136
36	1465	41.40	82.80	14.10	17.30	142
38	1706	43.70	87.40	14.90	18.40	150