

D RING WITH STRAP, TYPE C

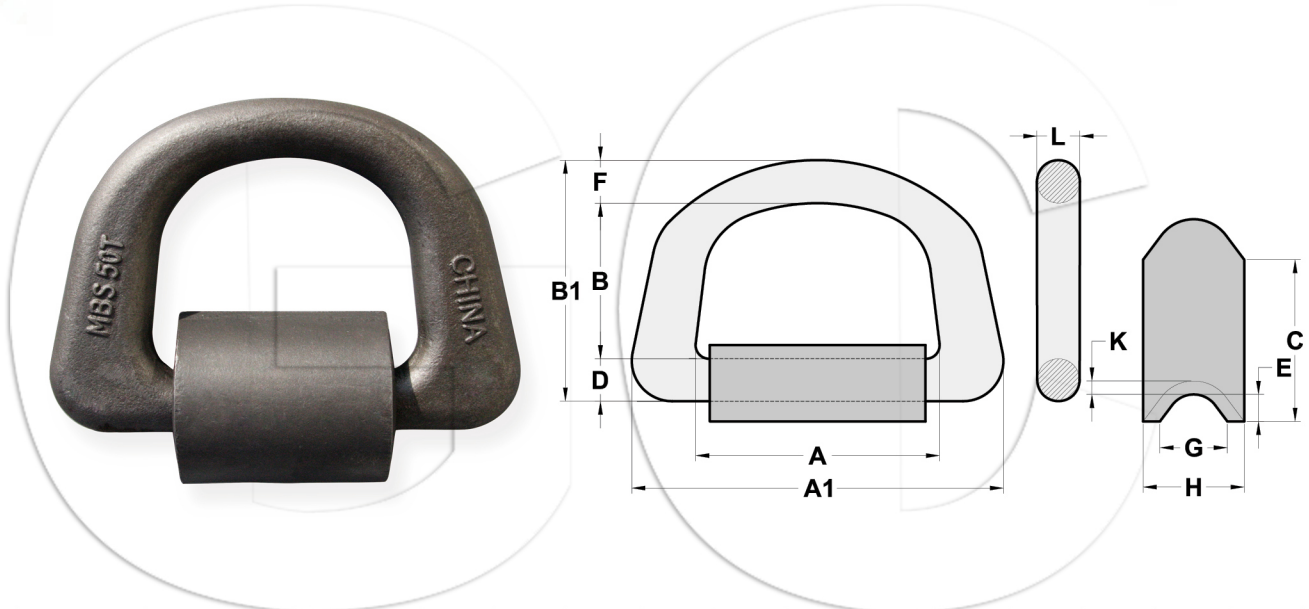

Size	Minimum Breaking Strength (T)	Weight Each (kg)	Dimensions (mm)											
			A	A1	B	B1	D	F	C	E	K	G	H	L
MBS7T	7	0.5370	65.5	123.1	51.1	76.1	12.7	12.3	50	16.2	5.9	32.2	42	12.5
MBS36T	36	2.5330	121	191.4	81	128.4	23.8	23.8	102	27	11.3	48.12	67	22.5
MBS41T	41	3.4040	126.5	202	92.8	144	25.9	25.3	102	31.8	13.5	63	82.5	25
MBS50T	50	4.1190	127	223	102	155	27.2	26.5	102	31	13.5	63	83	26.5

⚠ WARNING Never exceed Working Load Limit