

BS464 THIMBLES

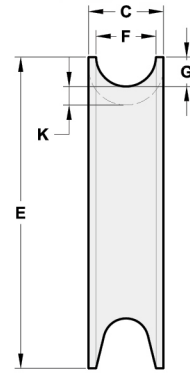

GOODCREDIT

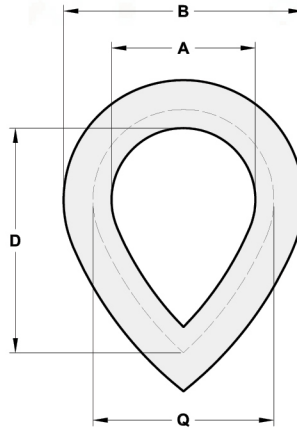

Nominal Dia of Rope		Approx Circle	A		B		C		D		E		F		G		K		Q	
in	mm	in	in	mm	in	in	mm	in	mm	in	mm	in	mm	in	mm	in	mm	in	mm	
5/16	8	1	7/8	22.2	1-1/2	1/2	12.7	1-5/16	33.4	2-1/8	52	4/16	7.9	5/32	4	5/32	4	1-3/16	30.1	
3/8	9	1-1/4	1	25.4	1-7/8	9/16	14.3	1-1/2	38	2-1/2	64	13/32	10.3	1/4	6.3	3/16	4.8	1-3/8	35	
7/16	11	1-1/2	1-1/8	28.6	2-1/8	11/16	17.5	1-1/2	41.3	2-7/8	73	1/2	12.7	5/16	7.9	3/16	4.8	1-1/2	38	
1/2	13	1-5/8	1-1/4	31.7	2-5/16	13/16	20.6	1-3/4	44.5	3-1/8	79.4	9/16	14.3	5/16	7.9	7/32	5.5	1-11/16	42.9	
9/16	14	1-3/4	1-1/4	31.7	2-5/16	13/16	20.6	1-3/4	44.5	3-1/8	79.4	9/16	14.3	5/16	7.9	7/32	5.5	1-11/16	42.9	
5/8	16	2	1-5/8	41.3	2-15/16	7/8	22.2	2-5/16	58.8	3-7/8	95.8	5/8	15.9	11/32	8.7	5/16	7.9	2-1/4	56	
11/16	17	2-1/4	1-3/4	44.5	3-1/8	1-1/8	28.6	2-5/8	66.6	4-1/4	108	3/4	19	3/8	9.5	5/16	7.9	2-3/8	60.4	
3/4	19	2-3/8	2	50.8	3-5/8	1-1/8	28.6	2-7/8	73	4-7/8	124	13/16	20.6	7/16	11.1	3/8	9.5	2-3/4	69.8	
13/16	21	2-1/2	2	50.8	3-5/8	1-1/8	28.6	2-7/8	73	4-7/8	121	13/16	20.6	7/16	11.1	3/8	9.5	2-3/4	69.8	
7/8	22	2-3/4	2-1/4	56	4	1-1/4	31.7	3-1/4	82.5	4-1/4	131	7/8	22.2	1/2	12.7	3/8	9.5	3	76.2	
15/16	24	3	2-1/2	64	5-11/16	1-5/16	33.4	3-5/8	92	5-3/4	146	1	25.4	1/2	12.7	13/32	10.3	3-5/16	84	
1	25	3-1/4	2-3/4	69.8	5-11/16	1-3/8	35	4-1/4	108	6-3/8	162	1-1/16	27	9/16	14.3	13/32	10.3	3-9/16	90.5	
1-1/8	29	3-1/2	3	76.2	5-1/4	1-1/8	38	4-3/8	112	7	178	1-1/8	28.6	5/8	15.9	1/2	12.7	4	102	
1-1/4	32	4	3-3/4	95	6	1-5/8	41.3	5-1/4	133	7-3/4	197	1-5/16	33.4	5/8	15.9	1/2	12.7	4-3/4	121	
1-3/8	35	4-1/2	4-1/8	105	6-7/8	1-7/8	47.6	6	152	9	228	1-1/2	38	3/4	19	5/8	15.9	5-3/8	137	
1-1/2	38	5	4-1/2	114	7-3/4	2-1/8	52	6-1/2	165	10	254	1-5/8	41.3	15/16	23.8	1-1/16	17.5	5-7/8	149	
1-5/8	41	5-1/4	4-1/2	114	7-3/4	2-3/16	58.6	6-1/2	165	10	254	1-11/16	42.9	15/16	23.8	1-1/16	17.5	5-7/8	149	
1-3/4	44	5-1/2	5	127	9	2-1/4	56	7	178	11-1/4	286	2	50.8	1	25.4	1	25.4	7	178	
1-7/8	48	6	5-1/4	133	9-3/4	2-5/8	66.6	7-1/2	190	12-1/4	317	2-3/8	60.4	1-1/8	28.6	1-1/8	28.6	7-1/2	190	
2	51	6-1/4	5-1/2	140	10-1/8	2-2/4	69.8	8	203	13	330	2-1/8	64	1-3/16	30.1	1-1/8	28.6	7-3/4	197	
2-1/8	54	6-1/2	5-1/2	140	10-1/8	2-3/4	69.8	8	203	13	330	2-1/2	64	1-3/16	30.1	1-1/8	28.6	7-3/4	197	
2-1/4	57	7	5-3/4	146	10-5/8	3	76.2	8-1/2	216	14	356	2-5/8	66.6	1-1/4	31.7	1-3/16	30.1	8-1/3	206	
2-1/2	64	8	6-1/4	159	12-1/4	3-3/4	95	9-1/2	242	16-1/4	414	2-3/4	69.8	1-3/4	44.5	1-1/4	31.7	8-3/4	222	