

ALUMINIUM FERRULES SPECIFICATION EN13411-3 (DIN3093)

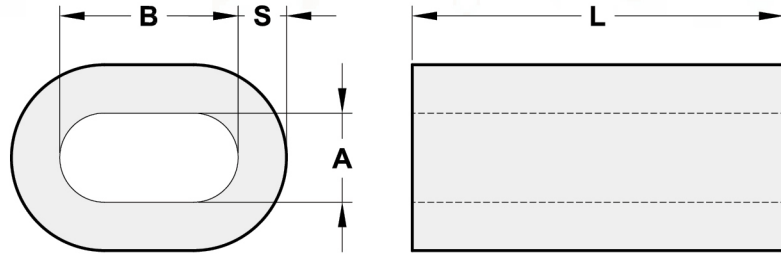

Ferrule Code	Weight Per 1000 (kg)	Dimensions (mm)			
		A	B	S	L
1	0.098	1.2	2.4	0.65	5
1.5	0.176	1.7	3.4	0.75	6
2	0.285	2.2	4.4	0.85	7
2.5	0.439	2.7	5.4	1.05	9
3	0.907	3.3	6.6	1.25	11
3.5	1.18	3.8	7.6	1.5	13
4	1.63	4.4	8.8	1.7	14
4.5	2.39	4.9	9.8	1.9	16
5	3.62	5.5	11.0	2.1	18
6	5.87	6.6	13.2	2.5	21
6.5	7.18	7.2	14.4	2.7	23
7	9.83	7.8	15.6	2.9	25
8	12.96	8.8	17.6	3.3	28
9	18.94	9.9	19.8	3.7	32
10	24.09	10.9	21.8	4.1	35
11	35.35	12.1	24.2	4.5	39
12	44.18	13.2	26.4	4.9	42
13	59.86	14.2	28.4	5.4	46
14	73.5	15.3	30.6	5.8	49
16	111	17.5	35.0	6.7	56
18	156	19.6	39.2	7.6	63
20	217	21.7	43.4	8.4	70
22	292	24.3	48.6	9.2	77
24	376	26.4	52.8	10.0	84
26	481	28.5	57.0	10.9	91
28	603	31.0	62.0	11.7	98
30	739	33.1	66.2	12.5	105
32	897	35.2	70.4	13.4	112
34	1077	37.8	75.6	14.2	119
36	1275	39.8	79.6	15.0	126
38	1503	41.9	83.8	15.8	133
40	1734	44.0	88.0	16.6	140
42	2024	46.2	92.4	17.5	147
44	2314	48.4	96.8	18.3	154
46	2662	50.6	101.2	19.2	161
48	3010	52.8	105.6	20.0	168
50	3412	55.0	110.0	20.8	175
52	3813	57.2	114.4	21.6	182
54	4293	59.4	118.8	22.5	189
56	4772	61.6	123.2	23.3	196
58	5326	63.8	127.6	24.2	203
60	5880	66.0	132.0	25.0	210